

# Tomalok

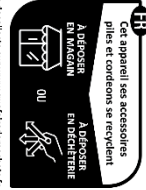
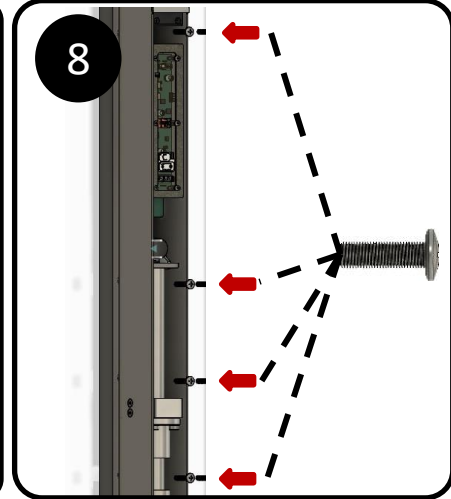
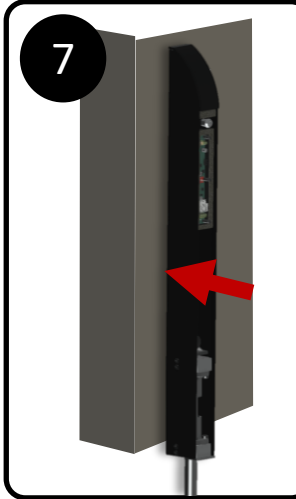
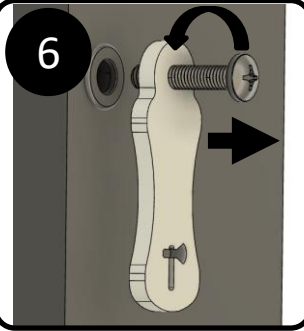
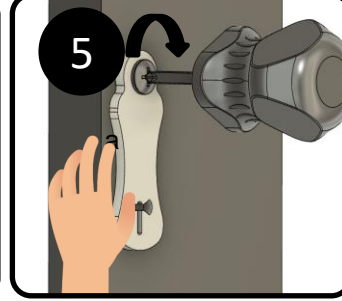
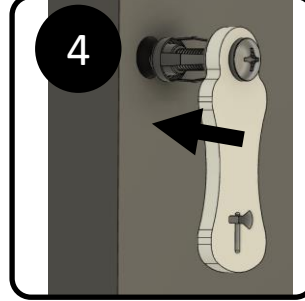
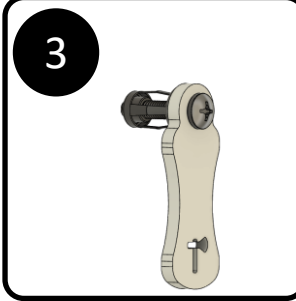
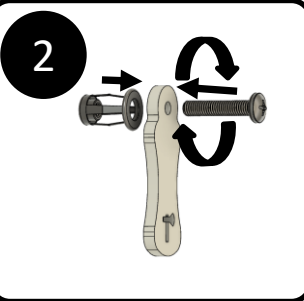
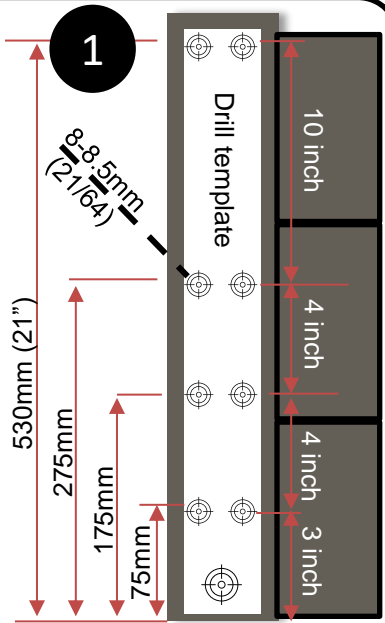
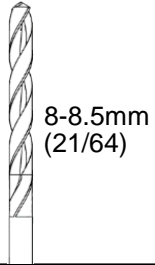
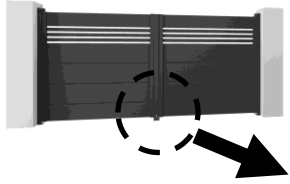

Note: Lock will auto detect ground level and stop automatically

Up to 150mm (6 inch) travel

20mm diameter solid stainless steel pin

9

It is recommended to install a metal ground plate to retain the pin. (sold separately or as part of some kits)

It is not advised to drill a deep and narrow hole into concrete. This can cause the pin to jam in the hole when lateral forces are applied to the gate.

If a ground plate is not being used, a minimum 38mm diameter (1.5 inch) hole is recommended, and not more than 38mm (1.5 inches) deep.

10

Mechanical Override engage / disengage

Hold up position (override)

Active position

**11** Choose / identify suitable output type on gate controller to trigger lock

- Lamp or flashing beacon output
- Courtesy light or volt free
- Lock/mag lock output (must be active for complete gate movement)

**12** Set bottom selector switch to appropriate mode

- Mode A**  
Volt free outputs
- Mode B**  
12-30v dc outputs

*TIP: If in doubt, test your gate controller output with a multi meter before connecting this device*

**13**

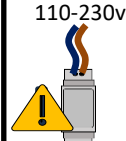

Gate motor controller

Mode A

Mode B

\*Optional PSU

\*Polarity sensitive 30v dc max

**14**

Activate PRE-WARNING ensures ample time for the pin to retract from ground before gates move



2-3 Seconds

**15**

Switch on & test

Ensure manual override disabled (step 10)

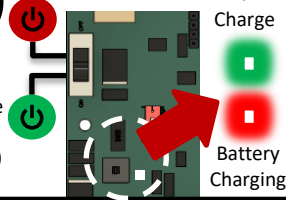

Full Charge  
Battery Charging

**Tomalok**

Examples

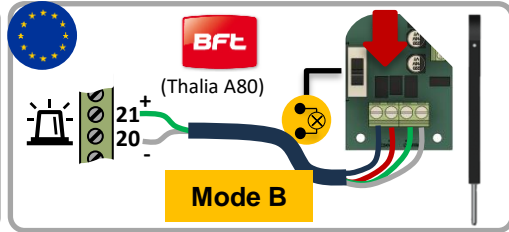
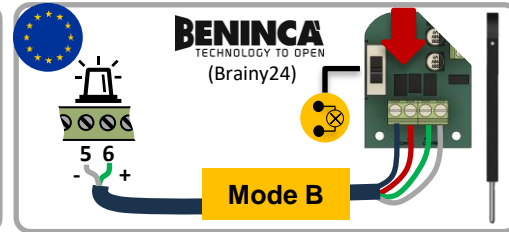
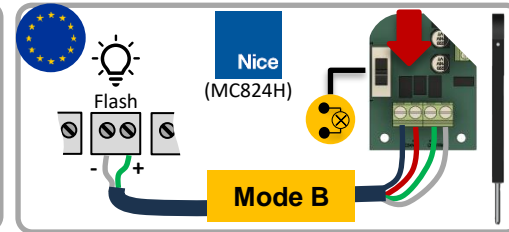
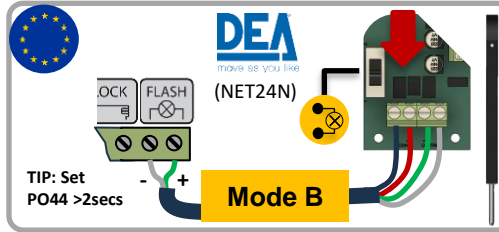
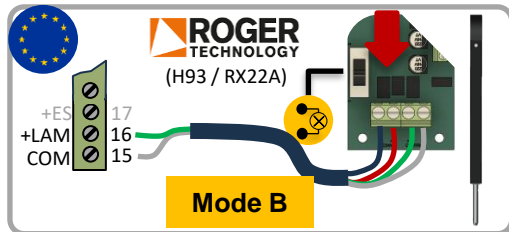
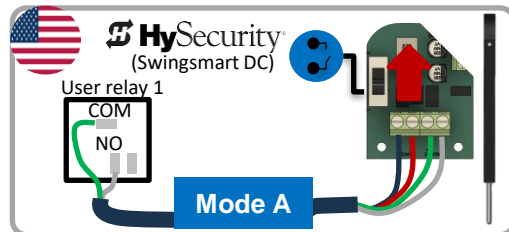
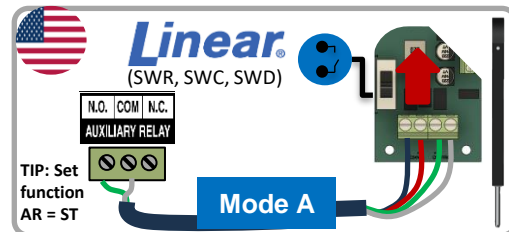
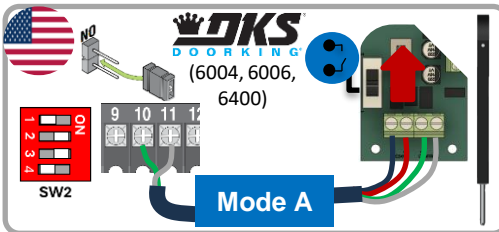
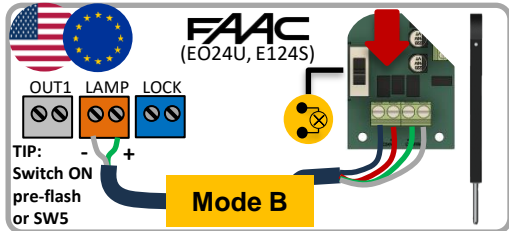
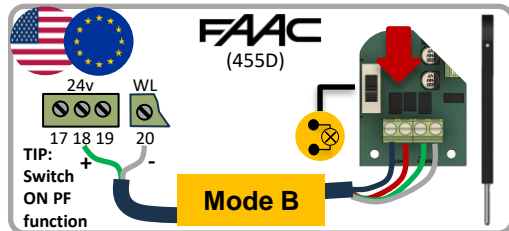
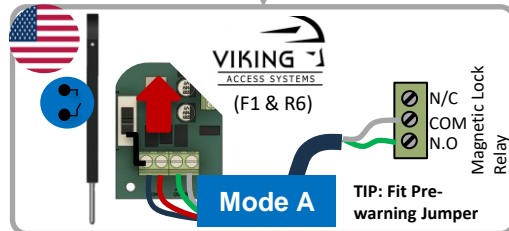
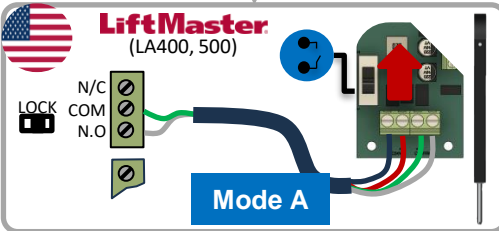

**Safety instructions:** Before proceeding with the product's installation, check that all the materials are in good working order and suited to the intended applications. Danger due to electric power. Contact with live parts may result in an electric current flowing through the body. Electric shock, burns, or death may result. Installation must be done by an authorized specialist.

**Disposal:** The packaging must be disposed of in the local recyclable containers. According to the European Directive 2002/96/EC on waste electrical equipment, this device must be properly disposed of, after usage in order to ensure a recycling of the materials used. Old accumulators and batteries may not be disposed of in the household waste, since they contain pollutants and must be properly disposed of in municipal collection points or in the containers of the dealer provided. Country-specific regulations must be observed. TOMALOK - 4C Kilcronagh Business Park, Cookstown, BT80 9HJ, UK. Product Type: Gate Lock